

ITEM NO.	PART NO.	DESCRIPTION	QTY.
1	H536	glider, 14" (bentley)	1
2	H599	manifold, vacuum, bentley	1
3	B237	compression fitting, 1/8 fpt x 1/4	1
4	H598	tube, 1/4", sol line, bentley	30"
5	B238	compression fitting, 90 deg, 1/4 mpt x 1/4	1
6	H458	nut, lock 10-32 thin	4
7	H464	gun, high pressure	1
8	B105	bushing, brass, 3/8"mpt x 1/4"	1
9	B193	swivel, 1/4" mpt x 1/4" fpt	1
10	B130	elbow, brass, 45 deg, 1/4" mpt x 1/4" fpt	1
11	B107	nipple, brass, 1/4"m, hex	1
12	B101	qd, brass, 1/4" m	1
13	H457	screw, 10-32 x 1-1/2", p-pan	4
14	H600	grip, 2", bentley	1
15	P538	clip, retainer, bentley	1
16	A950	tube, 2", bentley w/ welded 2" swivel	1
17	AH114	hose, 14" bentley	1
18	H354	manifold, solution, bentley	1
19	H394	screw, #10-24 x 1/2", p-pan	4
20	B108A	valve, brass, 1/8" check	4
21	B223	jet, 1/8" vv 95015 s/s	4
22	H851	clamp, jet manifold, bentley	1

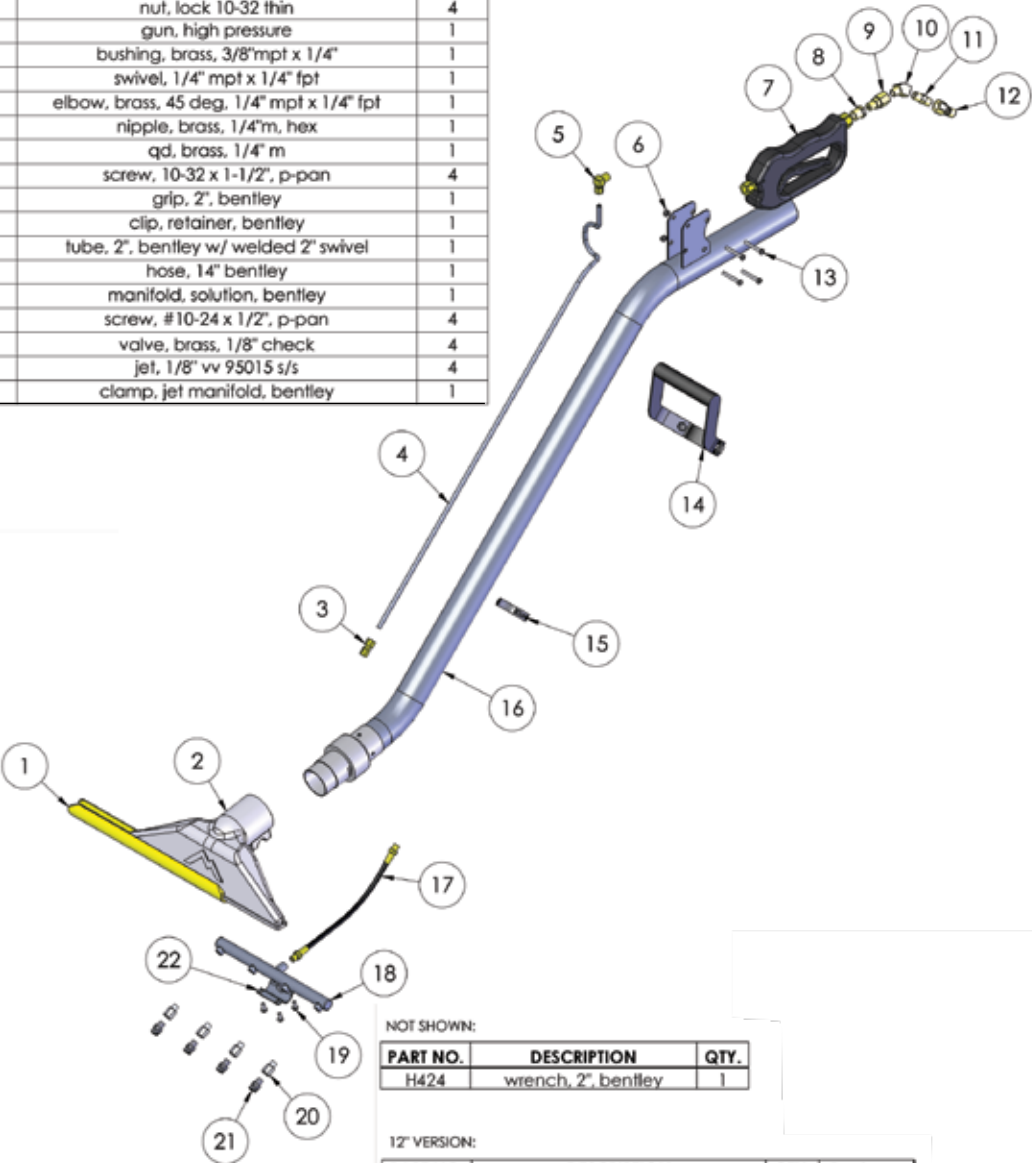

NOT SHOWN:

PART NO.	DESCRIPTION	QTY.
H424	wrench, 2", bentley	1

12" VERSION:

PART NO.	DESCRIPTION	QTY.	Replaces
H537	glider, 12" (bentley)	1	H536 (#1)
H603	manifold, 12" vacuum, bentley	1	H599 (#2)
H355	manifold, solution, bentley, 10"/12"	1	H354 (#18)

TALL VERSION:

PART NO.	DESCRIPTION	QTY.	Replaces
A950A	tube, tall, 2", bentley w/welded 2" swivel	1	A950 (#16)
H598	tubing, 1/4", s/s, .035 wall, sol line, bentley	37"	H598 (#4)

BENTLEY™ WAND



- Polished Aluminum Head
- Stainless Steel Check Valves
- Four Stainless Steel Jets
- Comfort Grip
- Swivel Head
- Low Profile
- Solution Line Swivel
- PTFE Banana Glide

OPERATING INSTRUCTIONS

1. Attach wand to the vacuum solution lines from your extractor.
2. Key wand trigger to clear air from lines. You should have a strong spray pattern when primed. (Note: The Bentley works best at pressures above 200 PSI.)
3. Adjust solution swivel to comfortable position.
4. Begin cleaning. Make two dry passes for each wet pass for maximum recovery.
5. When finished cleaning, key wand with extractor off to clear all solution from the line.
6. Between uses, store wand in warm, dry place. Do not allow unit to freeze.

MAINTENANCE & TROUBLESHOOTING

1. Clean jets regularly. Clogged or dirty jets can lead to irregular spray pattern. To clean, remove jet and use compressed air to clean. You may also soak the jets in Mytee System Maintainer (Item #3601) to remove hard water and chemical build up.
2. Keep glide orifices clean. The back of your Bentley wrench has a finger that can be used to clear these openings.
3. Keep head free of debris. Swivel head can be removed for cleaning using enclosed wrench. Lubricate regularly with a silicone lubricant.
4. Replace glide when worn. Replacement glides (Item #H536) can be ordered from your Mytee distributor.
5. Regularly inspect wand for worn or damaged parts as needed.
6. Clean aluminum head regularly. To restore luster, aluminum polish may be used.



MYTEE PRODUCTS, INC | 13655 STOWE DRIVE | POWAY, CA 92064
 PHONE: 858-679-1191 | FAX: 858-679-7814 | WWW.MYTEE.COM

SOME UNIQUE FEATURES OF YOUR NEW BENTLEY WAND:

REPLACEMENT GLIDES

#H536 - 12"

#H537 - 14"



SAFETY PRECAUTIONS

1. Designed for professional use.
2. Make sure all safety devices are in place and operating.
3. Use manufacturer supplies or approved replacement parts.
4. Keep all orifices clean and unblocked.
5. Do not exceed 3000 PSI when using the wand.
6. Do not run at temperatures higher than 250° F.
7. Do not leave wand unattended while pressurized.



WARRANTY

Mytee Products, Inc. endeavors to provide high quality products and product support to its customers and therefore backs up all of its new products purchased from Mytee Products Inc. ("Mytee") or any authorized Mytee distributor/service center with this limited warranty. This limited warranty begins on the date of the customer's purchase and is valid and available to the original purchaser only. Mytee's products are for commercial use only and are not intended for personal, family or household uses.

HOWEVER, OTHER THAN SET FORTH HEREIN, MYTEE GIVES NO WARRANTY, EXPRESS OR IMPLIED, AS TO DESCRIPTION, QUALITY, MERCHANTABILITY, FITNESS FOR ANY PARTICULAR PURPOSE, PRODUCTIVENESS, INFRINGEMENT, OR OTHER MATTER, OF ANY GOODS WHICH MYTEE SHALL SUPPLY. THERE ARE NO WARRANTIES WHICH EXTEND BEYOND THE DESCRIPTION ON THE FACE HEREOF. MYTEE SHALL IN NO WAY BE RESPONSIBLE FOR THE PROPER USE AND APPLICATION OF THE GOODS. MYTEE NEITHER ASSUMES NOR AUTHORIZES ANY OTHER PERSON TO ASSUME FOR MYTEE ANY OTHER LIABILITY IN CONNECTION WITH THE SALE OF MYTEE'S GOODS. THIS LIMITED WARRANTY POLICY MAY BE CHANGED OR WITHDRAWN BY MYTEE AT ANY TIME WITHOUT NOTICE.

WEAR PARTS 90-DAY LIMITED WARRANTY: Mytee will replace all wear parts for 90 days from the date of original purchase. "Wear parts" are items which wear out as a result of usage or the passage of time and are consumed despite attempts to maintain them, such as gaskets, wheels, brass, cords, wires, electrical terminals, hoses, switches, thermostats, plastisol parts, filters, bearings, brushes, solenoids, o-rings, bulbs, heating elements, castors, or other parts deemed wear items in Mytee's sole discretion. This warranty covers the cost of replacement only and does not cover shipping or labor costs.

PUMP, VACUUM MOTOR AND HEATER 1-YEAR LIMITED WARRANTY: Mytee warrants that pumps, vacuum and floor machine motors, and heaters will be free from manufacturing defects, defects in workmanship, and defects in material for one (1) year from the date of original purchase. This warranty does not apply and is void if the pump, vacuum motor, or heater has worn brush motors, water damage, chemical build-up, chemical damage, or evidence of abuse, neglect or tampering. This warranty covers the cost of replacement or repair only and does not cover shipping or labor costs.

HOUSING 5-YEAR LIMITED WARRANTY: For five (5) years from the date of purchase, Mytee warrants a percentage of the cost of replacement of rotationally-molded housings pro-rated as follows: Mytee will pay 100% of replacement cost in the first year from the date of purchase, 75% of replacement cost in the second year from the date of purchase, 50% in the third year, 25% in the fourth year, and 12% in the fifth year. Replacement cost does not include the cost of shipping or labor.

LIMITATION OF DAMAGES: THE REMEDY OF REPLACEMENT OR REPAIR OF ANY DEFECTIVE GOODS SHALL BE THE EXCLUSIVE REMEDY UNDER ANY WARRANTY MADE BY MYTEE, WHETHER EXPRESS OR IMPLIED. IN NO EVENT SHALL MYTEE BE LIABLE FOR ANY INCIDENTAL OR CONSEQUENTIAL DAMAGES, PROPERTY DAMAGES, OR PERSONAL INJURIES.

All limited warranties are void for, and Mytee does not warrant in any way, any product that evidences misapplication, improper installation, abuse, lack of maintenance, negligence in use or care, abnormal use, alteration of design, use of incompatible or corrosive chemicals, use in a rental service, and/or servicing, installation of parts, or repairs by anyone other than Mytee or a Mytee authorized distributor or service center.

Mytee may make changes in products it manufactures and markets at any time; these changes are made without obligation to change, retrofit, or upgrade any product previously sold or manufactured. Mytee has no obligation to honor the limited warranties set forth herein unless the original purchaser, promptly upon discovering the warranty claim and prior to continuing to use the product, contacts Mytee or a Mytee authorized distributor or service center to describe the claim and to receive and follow instructions for documenting and resolving the claim. In addition, the purchaser must provide the product to which the claim applies to Mytee or a Mytee authorized distributor or service center for a thorough inspection.

If any provision or portion of this limited warranty policy is found to be unenforceable, then the remaining provisions and portions shall remain valid and enforceable. If any provision or portion of this limited warranty policy is found to be limited by law, then that provision or portion shall be construed to make it effective within the bounds of law. For example, if there are legal limitations on the duration of warranties, the warranties made herein shall be construed to have the minimum duration required by law, or, if there are legal limitations of exclusion of remedies, the exclusions made herein shall be construed to apply to the fullest extent possible without violating the law.

The validity, construction and performance of this warranty policy shall be governed by the laws of the State of California, without respect to conflicts of laws principles. The exclusive jurisdiction of any legal action arising from or related to this warranty policy shall be in the State of California and no legal action shall be commenced elsewhere.